

PS0509DA

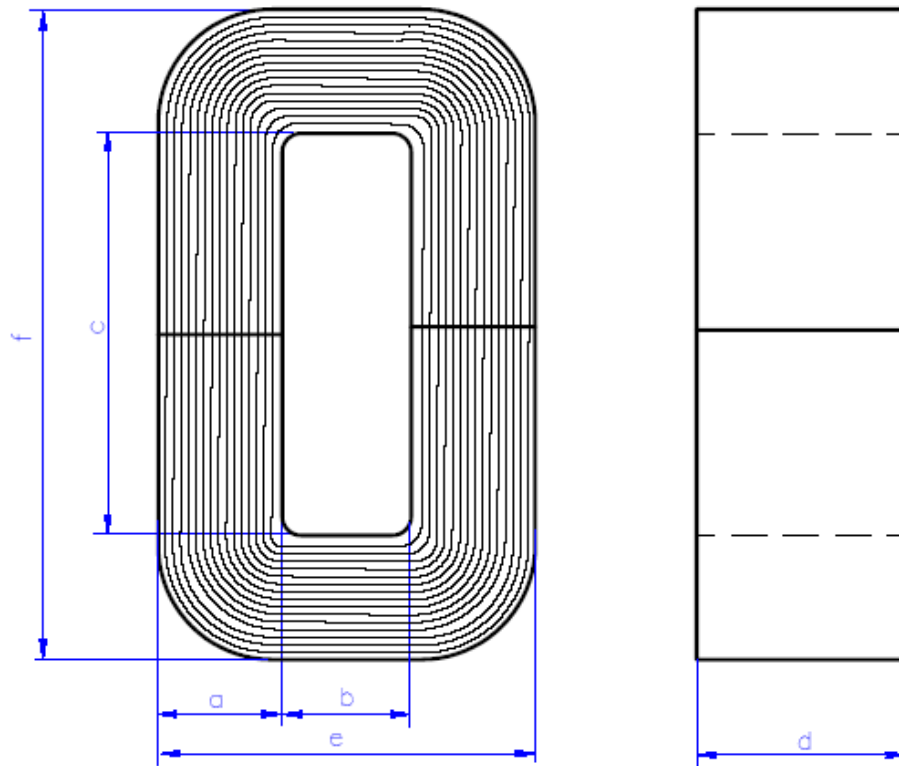

NOTE :-

1. ALL MEASUREMENTS ARE DONE AT ROOM TEMPERATURE.
2. WEIGHT INCLUDES 2% EPOXY WEIGHT.
3. CONTINUOUS OPERATING TEMPERATURE : 150°C
4. EQUIVALENT TO DIN SIZE SU102b.

CORE MATERIAL: METGLAS[®] ALLOY 2605SA1

CUSTOMER APPROVAL

COMPANY NAME:

NAME:

SIGNATURE:

DATE:

PHYSICAL SPECIFICATIONS

Core Build	(a) mm	32.70 ±1.0
Window Width	(b) mm	34.00+1.0/-0.0
Window Length	(c) mm	106.00+2.0/-0.0
Core Height	(d) mm	55.00±1.0
Core Width	(e) mm	99.40+3.0/-2.0
Core Length	(f) mm	171.40+4.0/-2.0
Mean Magnetic Path	(lm) cm	42.08
Net Area	(Ac) cm ²	14.75
Window Area	(Wa) cm ²	36.04
Area Product	(Ap) cm ⁴	532
Weight of Core	g	4182 (Min.)

ELECTRICAL SPECIFICATIONS

Core Loss @ 16kHz, 0.037 T ≤ 9.35 W

lm = mean magnetic path length

Ac = net cross-sectional area

Wa = core window area

NOTE :-

THIS DRAWING, THE PROPERTY OF HITACHI METGLAS INDIA PVT. LTD. IS FURNISHED SUBJECT TO RETURN ON DEMAND AND THE CONDITION THAT THE INFORMATION AND TECHNOLOGY EMBODIED HEREIN SHALL NOT BE DISCLOSED OR USED AND THE DRAWING SHALL NOT BE REPRODUCED OR COPIED IN WHOLE OR IN PART EXCEPT AS PREVIOUSLY AUTHORIZED IN WRITING. ANY PERSON WHO MAY RECEIVE OR OBSERVE THIS DESIGN WILL BE HELD STRICTLY LIABLE FOR ANY VIOLATION WHETHER OR NEGLIGENT.

EG/FM/11/1

TOLERANCES UNLESS OTHERWISE SPECIFIED	NO.	REVISION	BY	APPR.	DATE	DIMENSIONS	MM	DESCRIPTION	SHEET NO.	DRAWING NO.	REV. NO.		
						SCALE	N.T.S					PRODUCT DRAWING - PS0509DA	
						PROJECTION	THIRD ANGLE	MATERIAL	1 OF 1	PS0509DA	0		
						HITACHI METGLAS		SD	25/04/08	RG	25/04/08	RK	25/04/08
					DRAWN			DATE	CHECKED	DATE	APPROVED	DATE	